

RATZ-FATZ-BROT

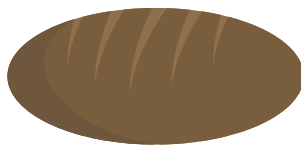

EINKAUF



VOLLKORNMEHL



LEINSAMEN



SALZ



APFELESSIG



HEFE

KÜCHE

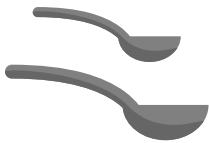

1 ESSELÖFFEL

1 TEELÖFFEL



SCHÜSSEL



KÜCHENWAAGE

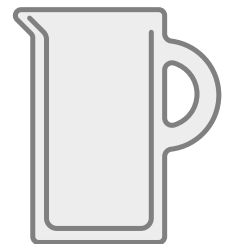

MESSBECHER

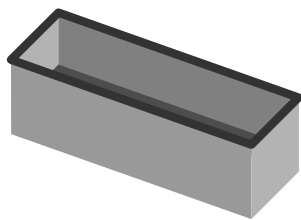

KASTENFORM

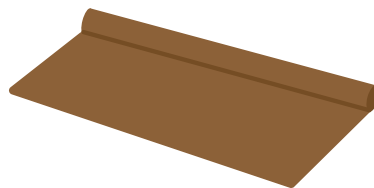

BACKPAPIER



RATZ-FATZ-BROT ZUBEREITUNG



500 g

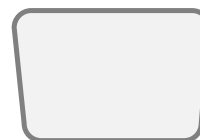

150 g



1



2



RATZ-FATZ-BROT ZUBEREITUNG

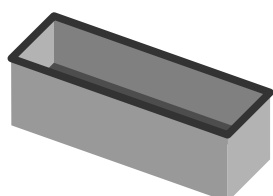
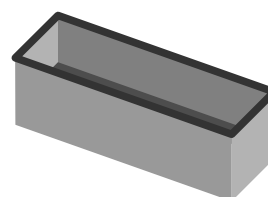
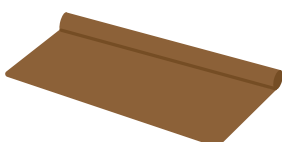
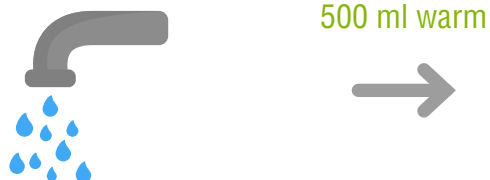
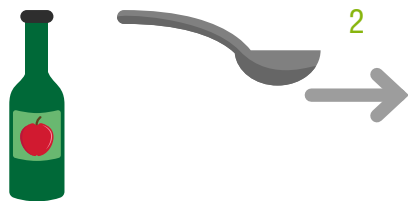

200 GRAD OBER-/UNTERHITZE

1 STUNDE

